

MONA OFFSHORE WIND PROJECT

Appendix to ExQ1 Q1.2.10 Indicative Temporary Construction Compound Layouts

Deadline: 3

Application Reference: EN010137

Document Reference: S_D3_25.3

Document Number: MOCNS-J3303-JVW-10339

30 September 2024

F01



Image of an offshore wind farm

Document status

Version	Purpose of document	Authored by	Reviewed by	Approved by	Review date
F01	Submission at Deadline 3	Mona Offshore Wind Ltd.	Mona Offshore Wind Ltd.	Mona Offshore Wind Ltd.	30 September 2024

Prepared by: **Mona Offshore Wind Ltd.**

Prepared for: **Mona Offshore Wind Ltd.**

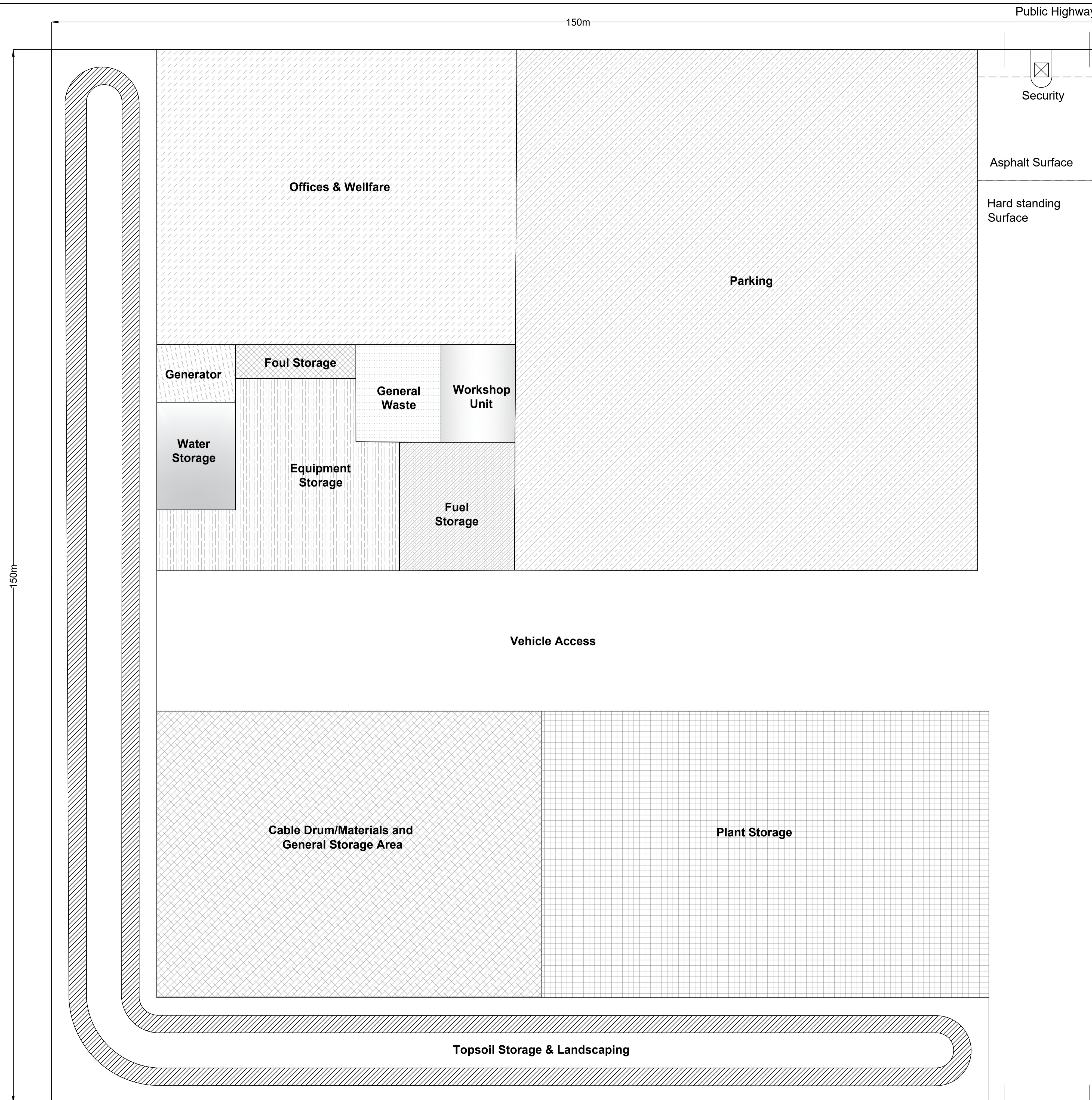

DO NOT SCALE FROM THIS DRAWING

NOTES

1. DO NOT SCALE FROM THIS DRAWING.
2. DRAWING IS INDICATIVE ONLY AND NOT FOR CONSTRUCTION PURPOSES.
3. DRAWING BASED ON MAXIMUM DESIGN ENVELOPE DIMENSIONS OF 150m X 150m FOR PRIMARY TCC FOOTPRINT AS PER DCO PARAMETERS.
4. LANDSCAPING AND TOP SOIL BUND LOCATIONS MAY VARY DEPENDING ON POTENTIAL LANDSCAPING NECESSARY AT EACH SITE LOCATION.
5. THE COMPOUND PERIMETER WILL BE FENCED AND ENTRANCE FROM PUBLIC HIGHWAY WILL BE SECURED BY A SECURITY CHECKPOINT.
6. SURFACE WATER DRAINAGE TO BE DESIGNED ON SITE BY SITE BASIS FOLLOWING DETAILED DESIGN OF TCC LOCATIONS.
7. INTERNAL ACCESS WITHIN LABELED POLYGONS NOT SHOWN.

A	FINAL FOR ISSUE	27/09/24	ZF	MW	AH
REVISION	DETAILS	DATE	DRAWN	CHECKED	APPROVED
CLIENT	MONA OFFSHORE WIND LIMITED				
PROJECT	MONA OFFSHORE WIND LIMITED				
DRAWING TITLE	ANNOTATED LAYOUT OF PRIMARY TEMPORARY CONSTRUCTION COMPOUND				
DRG No.	ED13798-GE-1071	REV	A	SUIT. CODE	
DRG SIZE	A1	SCALE	NTS	DATE	27/09/2024
DRAWN BY	ZF	CHECKED BY	MW	APPROVED BY	AH

UPDATED INDICATIVE MAIN TEMPORARY CONSTRUCTION COMPOUND LAYOUT NOT TO SCALE

Entrance & Exit To Haul Road



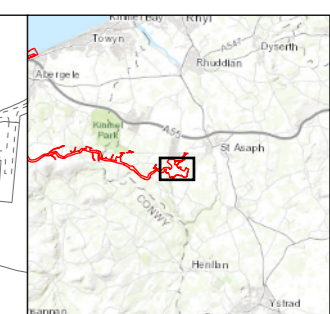
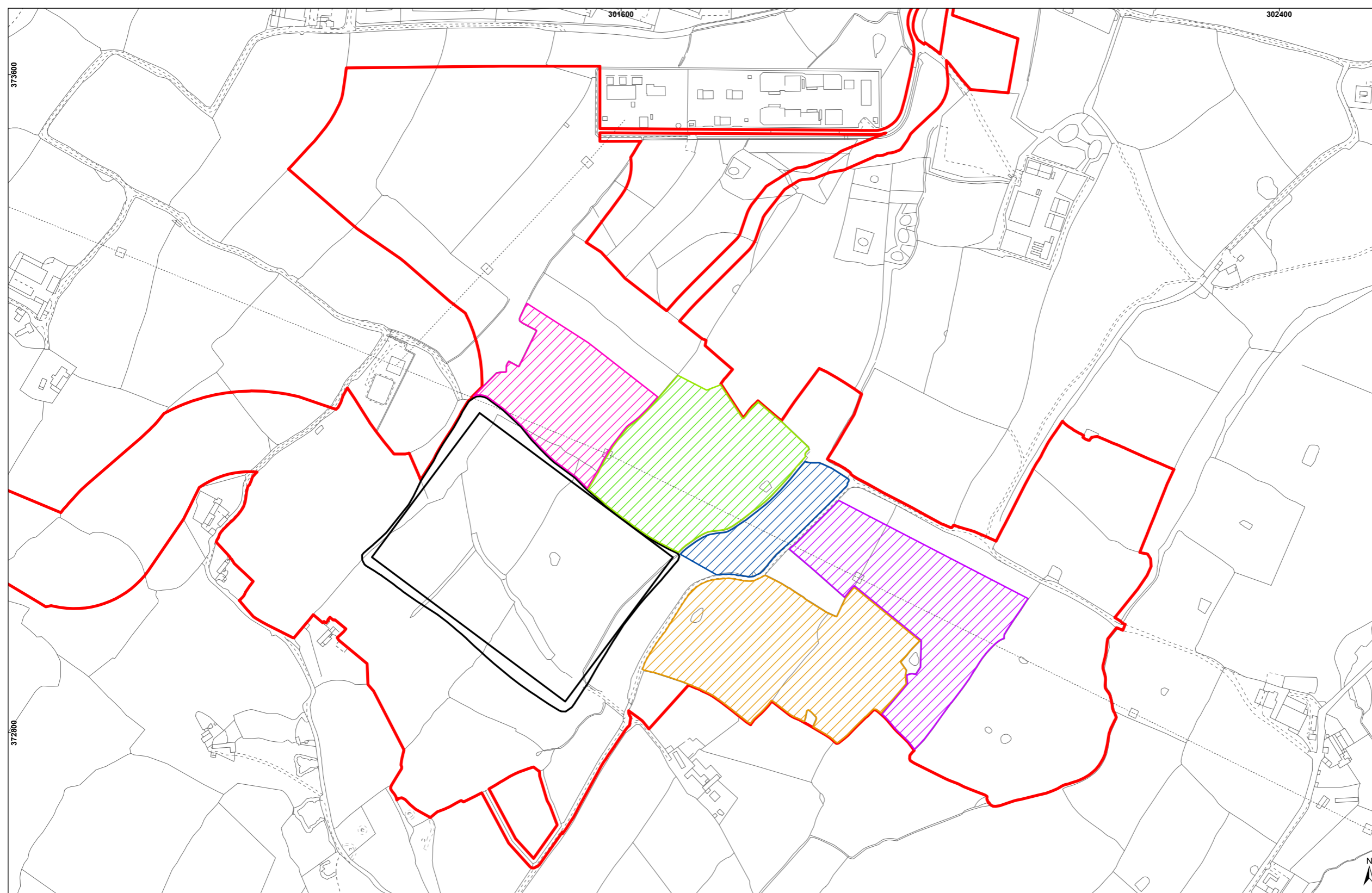

- LEGEND**
- ▭ Mona Onshore Order Limits
MO_PRJ_BP_0162_Rev11
 - Onshore Substation Earthworks Platform and Development Platform (Work No. 22 and Work No. 22a)
 - Offices, Welfare and Parking
 - Material Storage and Laydown Areas
 - Temporary Attenuation
 - Temporary Topsoil and Subsoil Storage
 - Offices, Welfare and Parking, and Temporary Attenuation and / or Permanent Attenuation

EnBW
Partners in UK offshore wind

BP
Partners in UK offshore wind

Drawing Number:
BP-GBR-MONA-REG-XXXX

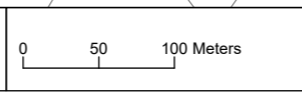

VER	DATE	DETAILS	BY	CHECK
01	19/09/24	Issued	TLD	PRW